

# Vending Machine Integration Manual

myPOS Sigma

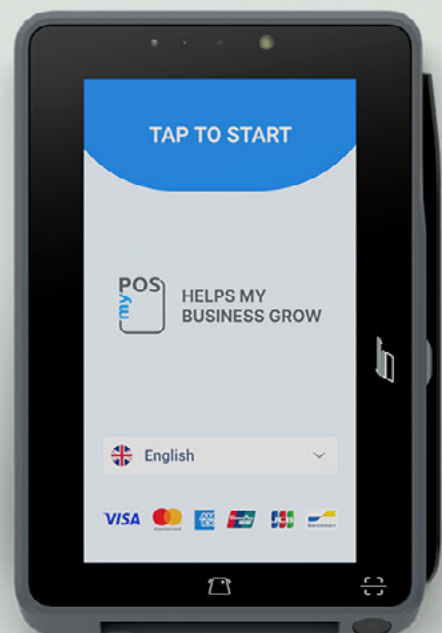

[mypos.com](https://mypos.com)

# Contents

<b>Introduction.....</b>	<b>1</b>
<b>myPOS Sigma - Modes of Operation.....</b>	<b>2</b>
Idle mode / Authorize – First .....	2
Always Idle mode/ Selection – First.....	3
<b>Integrating your vending machine with myPOS Sigma.....</b>	<b>3</b>
Start the terminal in "Idle mode" .....	3
Device configuration in "Idle mode" .....	3
Item purchasing process in „Always Idle mode“ .....	3
Start the terminal in "Always Idle mode" .....	4
Device configuration in "Always Idle mode" .....	4
Item purchasing process in "Idle mode" .....	4
<b>Terminal settings management .....</b>	<b>5</b>
Pairing myPOS Sigma with a vending machine.....	5
MDB Settings menu.....	6
Select an Item Screen .....	6
Idle mode payment standby .....	7
Idle mode funding settings.....	8
Support split payments .....	8
Force feature level 1 .....	9
Max amount.....	9
Item select time-out .....	10
Additional settings .....	10
<b>Mounting myPOS Sigma on a vending machine .....</b>	<b>11</b>
Installation .....	11
Installation of the 4G antenna .....	11
<b>FAQ .....</b>	<b>12</b>

# Introduction

myPOS Sigma is a specialised POS terminal designed for seamless integration with self-service systems and vending machines. It facilitates communication with vending machines through the widely recognised MDB protocol.

myPOS Sigma can work both as a standalone unattended device that accepts card payments and in integration with other additional payment devices on the vending machine (coin changers, bill validators, private label cashless devices and fiscal devices).

*Connecting myPOS Sigma to your vending machine or payment peripherals is a breeze. myPOS offers a convenient "MDB Interface" cable specifically designed to enable multiple devices to connect to the vending machine's MDB port.*

According to the merchant's needs, the vending machines can be configured to operate in an "MDB Interface" mode, in which the VMC controller of the vending machine is the master device. or They can also be configured to operate in an "Executive Interface" mode, in which the master of all connected devices is the coin changer. Regardless of whether the vending machine is set to operate in "MDB Interface" or "Executive Interface", myPOS Sigma supports various operational modes to suit the specific setup of your vending machine.

# myPOS Sigma - Modes of Operation

Vending machines have two main operating modes – “Idle” mode and “Always Idle” mode. To meet the specific setup of your vending machine, myPOS Sigma supports both modes of operation.

## Idle mode / Authorize – First

First, credit is loaded into the vending machine for the value of the most expensive item, and then we proceed with the actual item selection. Loading the credit can be achieved in two ways:

- **Virtual credit:** A virtual credit is initiated from the terminal. After selecting the desired item, myPOS Sigma will request processing a payment for the exact value of the item. “Virtual credit” is the standard operating model of myPOS Sigma.
- **Authorisation of the full amount:** The terminal initiates payment for the value of the most expensive item. After selecting an item, if its price is lower than the authorised amount, a partial refund of the balance will be made to the customer’s bank account.

In “Idle mode / Authorize – First”, the terminal can be set to always expect a payment or expect an interaction with the users in some form. myPOS Sigma provides the following options for user interaction: touching the display; taping a card or via a proximity sensor. All options could be used simultaneously or just one of them can be selected.

### Important

- *myPOS Sigma automatically switches between “Idle” mode and “Always Idle” mode, depending on the mode in which the vending machine has been set to operate.*
- *If the vending machine does not communicate the price of the most expensive item to myPOS Sigma, a default amount of 10 EUR will be initiated as a credit. The value of the amount can be edited via the terminal settings menu.*
- *The default item selection time is set to 30 seconds, however, this can also be adjusted from the settings menu.*
- *If the proximity sensor is activated, actions with other peripheral payment devices are impossible until the timeout expires.*

## Always Idle mode/ Selection – First

In this mode, the first step is the item selection, followed by payment at the myPOS terminal.

### **Important**

- *For this mode, if the vending machine is set to work in "Executive Interface", it is necessary to increase the item selection timeout period of the coin changer or the vending machine to 20 seconds.*

## Integrating your vending machine with myPOS Sigma

In this section, we will go through the steps required to set up the POS device to work with your vending machine in one of the available modes ("Idle"/"Always Idle").

During the initial start-up of the device, if the terminal works in "Idle mode", the default setting is set to always expect user interaction, and the credit made will be of a virtual amount.

### Start the terminal in "Idle mode"

#### **Device configuration in "Idle mode"**

1. Connect the terminal to the MDB port of the vending machine or to the MDB output of the coin changer via the MDB Interface cable.
2. Switch on the vending machine.
3. Change the operating profile of the device by selecting *Pair device > MDB* from the settings menu.
4. Restart the vending machine and the terminal will be ready for action.

#### **Item purchasing process in "Idle mode"**

1. To initiate a card payment, press "Tap to start" on the terminal screen.
2. Virtual credit will be loaded into the vending machine.
3. After selecting an item from the vending machine, payment will be initiated at the terminal for the value of the item.
4. The customer pays by card and receives the selected item.

## Start the terminal in "Always Idle mode"

### Device configuration in "Always Idle mode"

1. Connect the terminal to the MDB port of the vending machine or to the MDB output of the coin changer via the MDB Interface cable.
2. Switch on the vending machine.
3. Change the operating profile of the device by selecting *Pair device > MDB* from the settings menu.
4. Restart the vending machine and the terminal will be ready for action.

### Item purchasing process in "Always Idle mode"

1. After selecting an item from the vending machine, payment will be initiated at the terminal for the value of the item.
2. The customer pays by card and receives the selected item.

### Important

- *If myPOS Sigma will be processing transactions in HUF or ISK currencies, it is necessary to set the number of characters after the decimal to zero. This is done via the vending machine settings.*

# Terminal settings management

To access the settings menu, use the following key combination:

**Press both the "volume +" and "volume -" buttons located on the back of the terminal twice.**

The first time you enter the terminal settings, you will be prompted to set a password for future access. By default, access to the status and navigation bars is limited.

## Pairing myPOS Sigma with a vending machine

1. Enter the settings menu of the device
2. Choose "Pair device" (**Figure-1**)
3. Choose "MDB" (**Figure-2**)

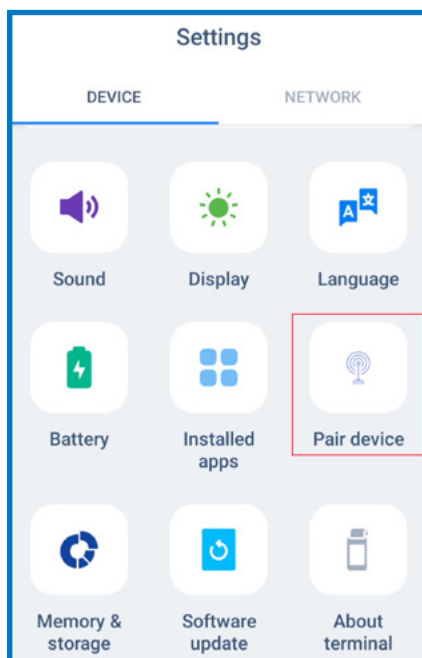

**Figure-1**

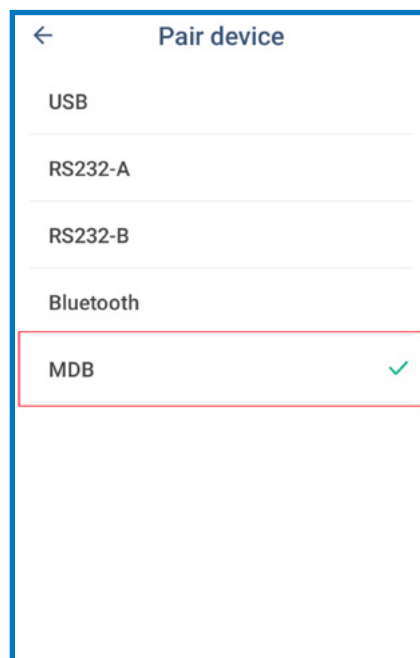

**Figure-2**

## MDB Settings menu

“MDB Settings” are located in “About terminal”.

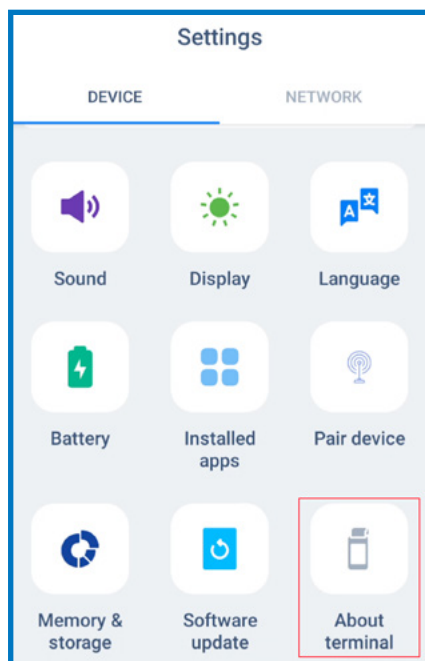

Figure-3



Figure-4

In the “MDB Settings” menu, the following options can be chosen:

### Select an Item Screen

Changing the animation that prompts the customer to select an item is done from “Select an Item Screen”.

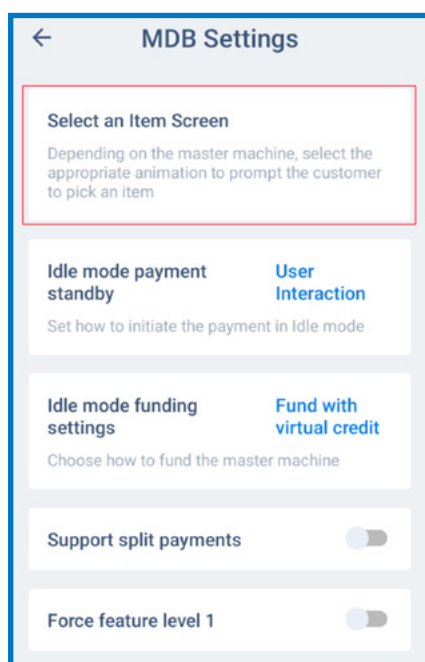

Figure-5

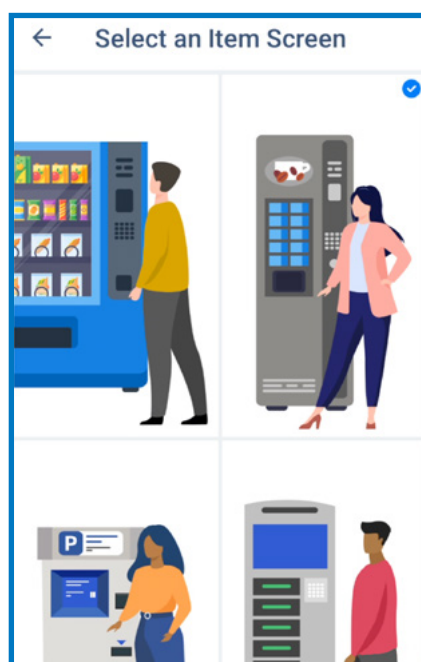

Figure-6

## Idle mode payment standby

Select how payment will be initiated in “Idle mode” to load credit into the vending machine.

- **Always on** - In this mode, the terminal is always on the card payment waiting screen.

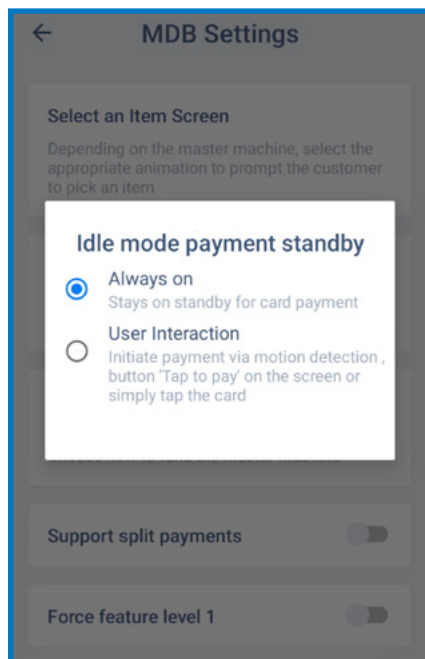

Figure-7

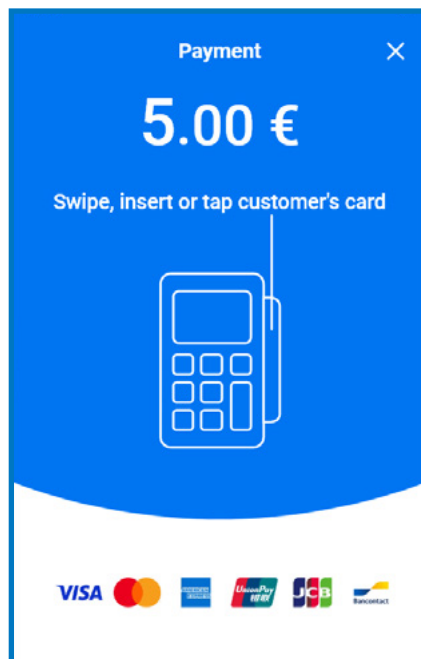

Figure-8

- **User interaction** by allowing any or all options to be selected: proximity sensor; screen button “Tap to Start”; tap with card to initiate payment.

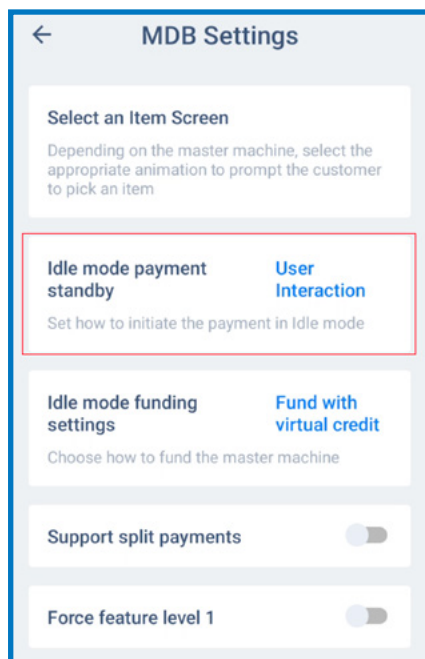

Figure-9

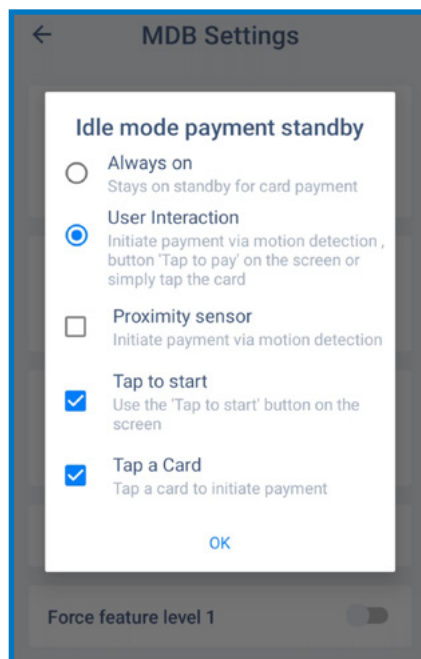

Figure-10

## Idle mode funding settings

How to power the vending machine options - authorisation with the full amount or powering with virtual credit.

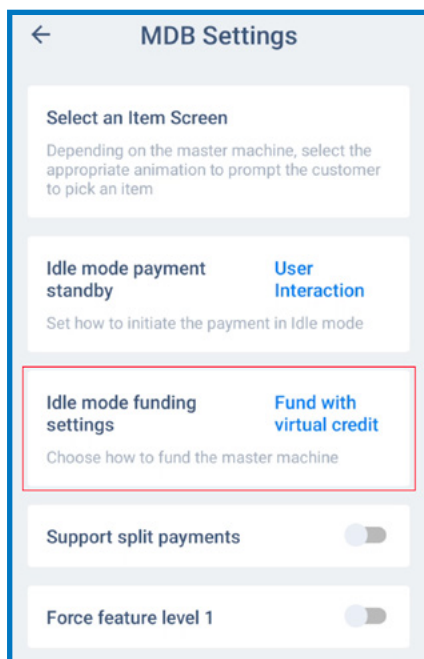

Figure-11

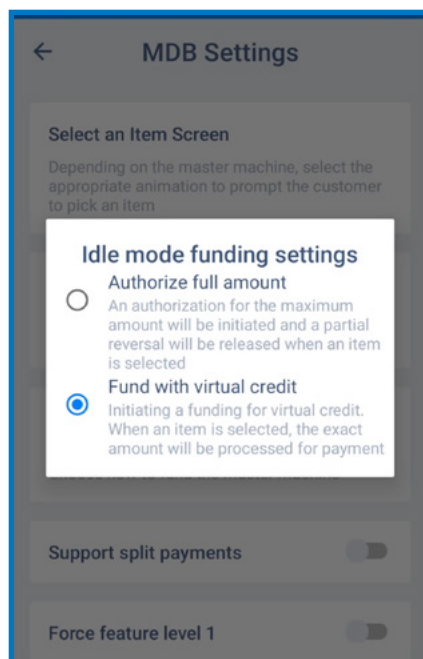

Figure-12

## Support split payments

Supports more than one payment method to settle a single purchase (card; coins; cash etc.). By default, the functionality is turned off.

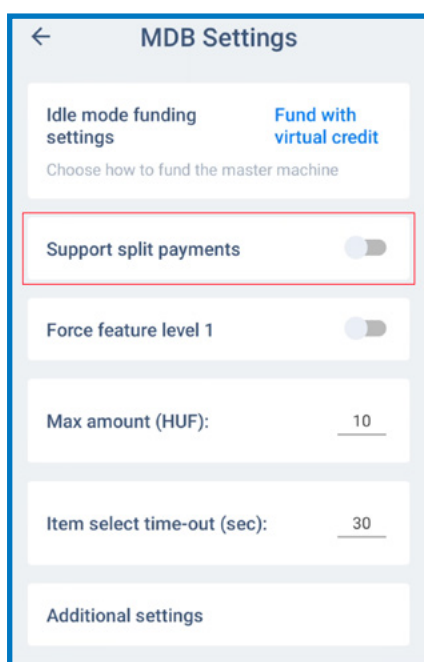
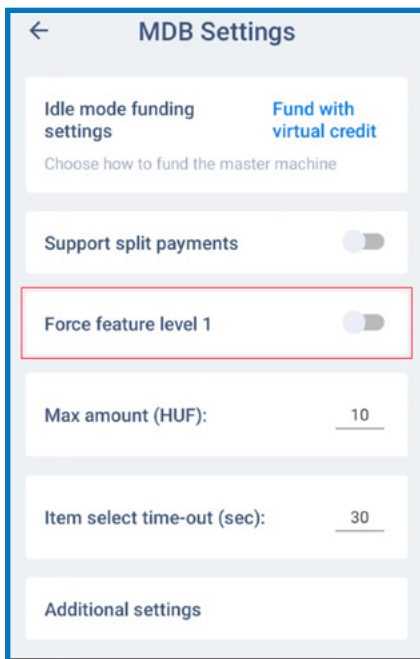

Figure-13

## Force feature level 1

If necessary, the terminal can be compelled to work with version 1 of the MDB protocol.



**Figure-14**

## Max amount

Adjust the "Max amount" that a vending machine will be loaded with if it doesn't provide price information for its most expensive item.

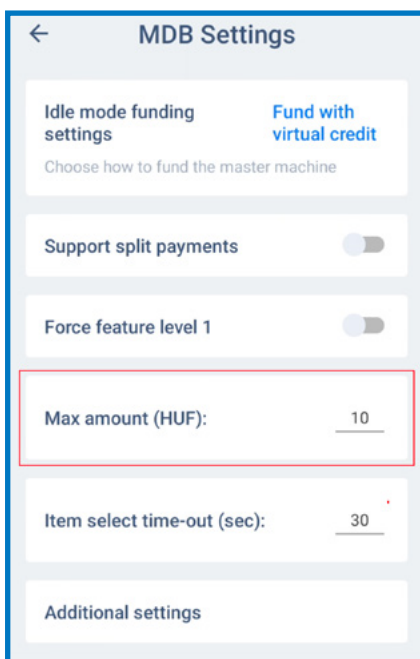

**Figure-15**

## Item select time-out

Adjust the duration (in seconds) for which the terminal will wait for an item to be selected.

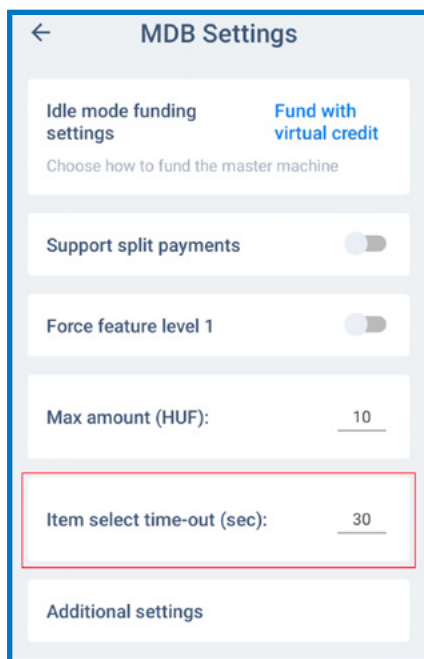

**Figure-16**

## Additional settings

Additional settings for Static PIN pad, MC Sonic Branding and Visa Sensory Branding.

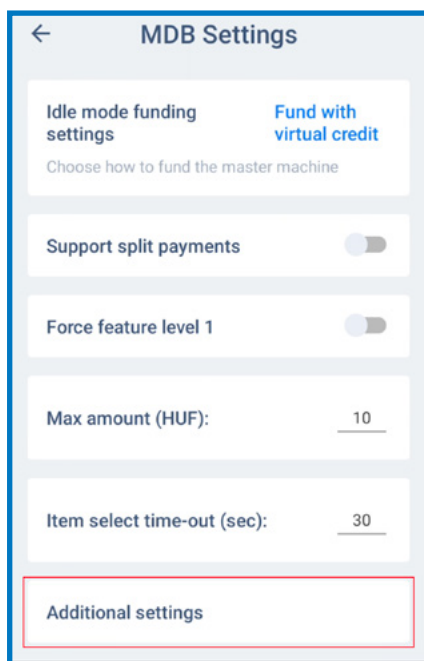

**Figure-17**

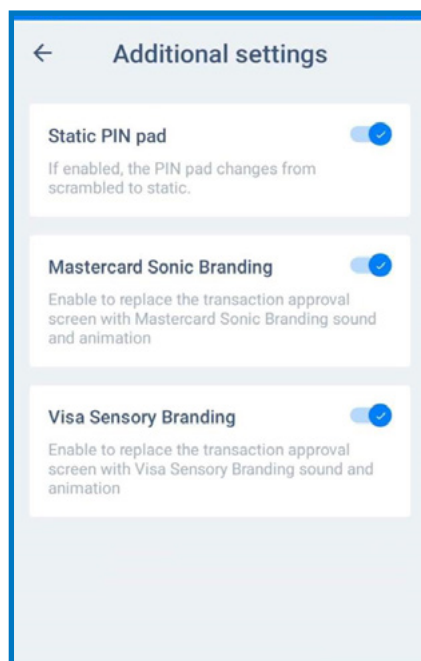
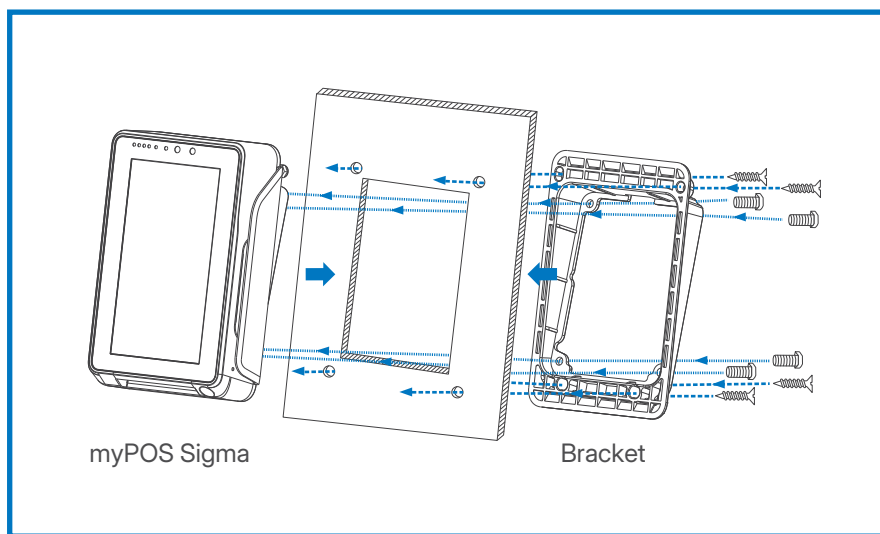

**Figure-18**

# Mounting myPOS Sigma on a vending machine

## Installation

1. Drill holes in the board wall according to the size of the POS terminal.
2. Separate the POS terminal from the bracket and install the POS terminal on the board wall.
3. On the back of the board wall, close the brackets and then screw them in place. **(Figure-19)**



**Figure-19**

## Installation of the 4G antenna

1. Remove the protective case of the antenna. **(Figure-20)**
2. Install the antenna to the SMA port of myPOS Sigma **(Figure-21)**. For security purposes, we recommend positioning the antenna inside the vending machine.

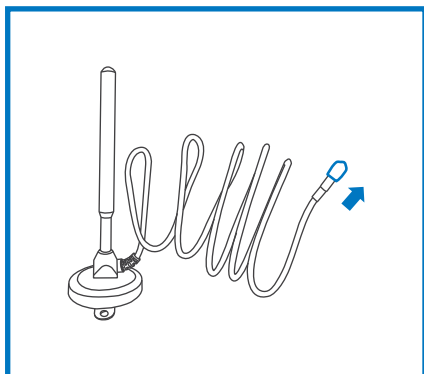

**Figure-20**

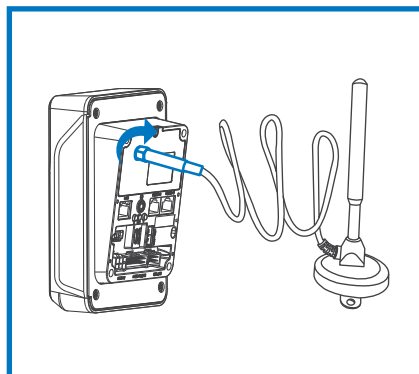

**Figure-21**

### **Does myPOS Sigma support the "Executive" protocol?**

No, however, if the coin changer is connected to the vending machine via the "Executive" protocol, myPOS Sigma can be connected to the MDB output of the coin changer and the communication between them will use the MDB protocol.

### **Is there a difference between the item price and the authorisation amount?**

It is necessary to set the price lists on all pricing layers of the vending machine because different price lists are responsible for the various payment methods (cash, cashless, etc.).

### **There is no mobile network coverage at the location of the vending machine. What should I do?**

Since the successful operation of the terminal requires internet access, you can connect the terminal to a Wi-Fi network or an Ethernet network. This is done via the settings menu of the terminal.

### **Can I forcefully change the FEATURE LEVEL (MDB Version) to version 1?**

myPOS Sigma operates on a protocol version set by the master device. Yes, this can be done from the terminal's MDB settings.

### **Do I have to manually input the amount of the most expensive item in the terminal settings when changing the prices of the products?**

If your vending machine can send the maximum and minimum price settings for a product, you don't need to change the amount when you change the prices of your products. The most common reason why the vending machine does not send the value of its most expensive item is that in one of the price lists of the VMC controller or coin mechanism, the price of an item is missing.

### **Is myPOS Sigma compatible with all models of coin changers?**

myPOS Sigma works with all coin changers supporting MDB communication. We have successfully tested the device with the most popular coin changers: MEI CashFlow (MARS) 690, MEI CashFlow 7900, MEI Gryphon and AETERNA - Coges.

### **Is myPOS Sigma compatible with all models of vending machines?**

myPOS Sigma works with all vending machines using MDB protocol. We have successfully tested the device with the following vending machines: Vendo Sanden, Saeco, Astro, Necta Canto, Tango and Kalea.

### **Can I integrate additional payment devices together with myPOS Sigma?**

Yes, if there are other payment devices in the vending machine, they can be connected to the free port of the MDB Interface cable.